

Dustie

Dustie Air Sanitizer 瑞典 达氏 空气消毒机

DAS180 Air Sanitizer

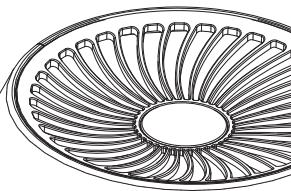

Please read this operating manual,
before using this product.
(请在使用本产品前, 阅读本操作手册)

Version : 1802021V2

Safety Instructions

- Please read the operating manual carefully before use and keep it properly for future reference.
- This manual is applicable to DAS180 series models. Please operate according to the instructions of the purchased model.
- When using electrical appliances, we should have basic safety knowledge to avoid fires, electric shocks and other injuries.

You are expected to follow the tips below:



Place the product at least 10 cm away from the obstructing object.



Do not cover the surface of the product with objects such as towels, to keep the surrounding air flowing.



Use the product safely to avoid fires, electric shocks and other injuries.



Please use this product in a room on a horizontal desktop with air circulation.



Do not place the product in a place where it is easy to touch the curtains.



The air sanitizer must be erect in operation.

Safety Instructions



Do not operate the product with wet hands. Do not wash the product directly with water.



It is forbidden to block the inlet and outlet with foreign objects. The product contains an internal high-speed rotating motor, please avoid accidental injury or damage to the product.



It is forbidden to use the air purifier as a toy for children to play.



If the power cord is damaged, in order to avoid danger, it must be replaced by the manufacturer's maintenance department or a professional in a similar department.



Do not use the product in a bathroom or in a place with gas.



Non-professionals or unauthorized repair personnel are not allowed to repair or modify the product by themselves.

【 Preparation prior to use 】

- Take out the product from its packing box and place it on a table or flat floor. The body of the product should be at least 60cm or more away from the walls or other home furnishing to promote air circulation.
- Prevent children or people who do not understand this product from using it. You can start to use the air sanitizer and enjoy the fresh air.
- Caution: Please remove all packing materials before use so as not to block the air inlet and outlet.

Parts Name

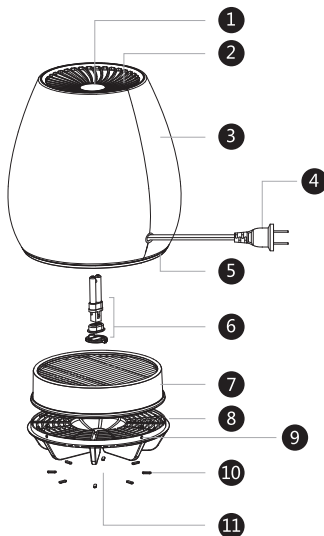

- | | | | | | |
|----|---------------|----|---------------|---|------------------|
| 1 | Control panel | 2 | Air outlet | 3 | Body |
| 4 | Power cord | 5 | Ambient Light | 6 | UV lamp assembly |
| 7 | Filter | 8 | Inlet grille | 9 | Buckle |
| 10 | Foot pad | 11 | Inlet | | |

Component specifications

Product	Dustie Air Sanitizer
Model	DAS180
Rated voltage	220V ~ /50Hz
Input power	10W
Dimensions	240 (width) X 281 (height) mm
Mode of dust collection	Backward centrifugal air duct system
Air Volume	100m ³ /h
Sterilization rate	>99% (*1)
Ammonia CADR	60m ³ /h (*2)
Applicable area	30-45m ³
Weight	2.16 kg

*Note 1: Section 5.3 of the implementation standard GB2155.3-2010 Appendix A

*Note 2: Section 5.5.2 of the implementation standard GB/T 18801-2015 Appendix C

*Note 3: GB4706.1-2005/4706.45-2008

Operating instructions and product maintenance

I. Product Operation

1. Place the machine on the horizontal desktop and make sure to follow the precautions on the first page.

2. Plug in the power

Plug the machine power cord into a power socket with a voltage of 220V and a frequency of 50Hz, and ensure good contact. Note: Do not plug or unplug with wet hands to avoid electric shock. Unplug the power cord when moving the machine.

3. On/off

Tap the power button (⏻), and the display screen will appear and the product powers on; press the power button again the product will power off. The on/off chord and keypad tone of the product will ring to indicate that every touch action is effective.

4. Mode switching

Tap the mode button (🔄) after powering on to switch the mode. The order is shown as in the right illustration:

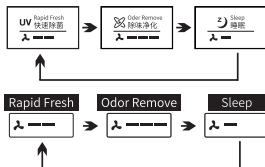

5. Wind speed

The air speed key automatically switches the optimal wind speed with the mode. The order is shown as in the right illustration:

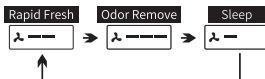

6. Filter / UV lamp replacement/reset

Once the service life of the filter / UV lamp ends, the product will enter replacement alert mode. At the same time, the warning page will appear on the product display and the fan will stop, which indicates that the filter or UV lamp needs to be replaced in case that the old filter or UV lamp will adversely affect your health.



(How to reset: Press and hold the power button (⏻) + the mode button (🔄) for over 3 seconds to release from the alert mode)



Note: if the filter screen is not installed or is not installed correctly, the display screen will give a warning. At this time, please install the filter screen correctly according to the instructions, and the product will automatically resume work.







Operating instructions and product maintenance

7. Factory reset

If the filter / UV lamp is replaced before the ending of its service life, it is necessary for the operator to manually switch to factory mode to reset!

Otherwise the "Service life expires" alert of the newly-replaced filter / UV lamp will appear earlier.

How to reset: Press and hold the power button  + mode button  for over 3 seconds in standby mode to enter the factory reset interface as shown in Figure (1). Refer to Figure (2) to reset accordingly: Press the mode button  to reset the filter, and press the power button  to reset the UV lamp. Once the reset is completed, the product will automatically enter standby mode in 3 seconds. Press the power button again to power on, and the product will work as normal.

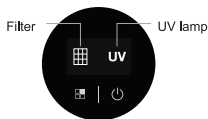

Figure (1)



Figure (2)

8. Ambient light on/off

Tap the power button twice to turn the ambient light on or off. Each time the power is turned on, the ambient light is default to "on".

Note:

Depending on the use environment, the filter should be replaced every 3-6 months;

Replace the UV lamp once every 1-2 years.

Operation instructions

II. Filter replacement

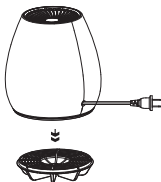

1. Turn off the machine, unplug the power, and take off the inlet grille.

- A. Press the power button to turn off the machine;
- B. Unplug the product power cord;
- C. After turning the product upside down, gently pull the air inlet grille out in the direction of the arrow.

2. Remove the old filter

Hold the filter handle and remove the old filter in the direction of the arrow.

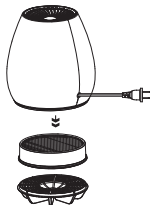

3. Take out the new filter

Use a pair of scissors to open the sealed bag of the new filter and take out the new filter.

Product maintenance

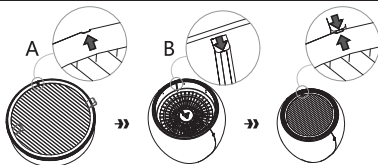

4. Install the new filter

Hold the handle of the new filter with both hands and place it vertically into the filter slot of the main unit.

Note: The arrow A of the filter should be placed vertically at the position of the filter slot B.

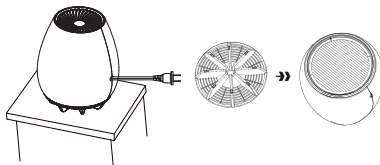



5. Install the inlet grille

Place the inlet grille vertically into the main unit in the direction of the arrow.

Then place the product on a horizontal desktop and plug it in again.

Note:

1. Every time the filter is replaced with a new one, it is required for you to follow the instructions on the display to manually reset before using the product!

How to reset: Press and hold the power button  + the mode button  for over 3 seconds to release from the alert mode. Then you can be assured to continue to use the product.

2. If the filter is replaced before the ending of its service life, it is necessary for the operator to manually switch to factory mode to reset (See the instructions in "Factory reset" for details!)

Product maintenance

III. UV lamp replacement

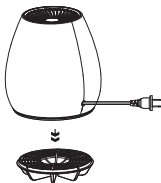

1. Turn off the machine, unplug the power, and take off the inlet grille.

- A. Press and hold the product power button for more than 3 seconds to turn off the machine;
- B. Unplug the product power cord;
- C. After turning the product upside down, gently pull the air inlet grille out in the direction of the arrow.

2. Remove the filter

Hold the filter handle and remove the old filter in the direction of the arrow.

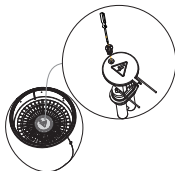
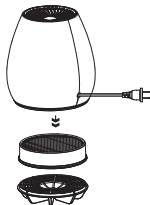

3. Remove the old UV lamp tube

Use a professional screwdriver to release and remove one of the screws. Remove the security cover of the UV lamp. Release the two terminals of L / N electrode to pull out the UV lamp along the axial direction.

Important: When removing the UV lamp tube, the power supply must be disconnected to prevent electric shock.

Product maintenance

4. Install a new UV lamp tube

- A. Take out a new UV lamp tube carefully, and put a sheath on the UV lamp
- B. Insert the UV lamp in the base of the product
- C. Insert the L / N electrode terminals back
- D. Close the UV lamp cover
- E. Secure firmly with the self-tapping screw

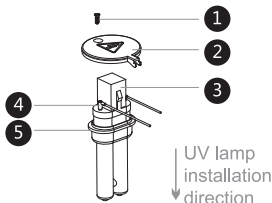



- 1 Self-tapping screw
- 2 UV lamp cover
- 3 UV lamp
- 4 L/N terminal
- 5 UV lamp sheath

5. Install the filter and cover with the air inlet grille

Reinstall the filter (pay attention to the alignment) and cover with the air inlet grille. Follow the instructions on the display to power on.

Note:

1. Every time the UV lamp is replaced with a new one, it is required for you to follow the instructions on the display to manually reset before using the product!

How to reset: Press and hold the power button  + the mode button  for over 3 seconds to release from the alert mode. Then you can be assured to continue to use the product.

2. If the UV lamp is replaced before the end of its service life, it is necessary for the operator to manually switch to factory mode to reset (See the instructions in "Factory reset" for details)!

Product maintenance

IV. Cleaning and Maintenance

Please unplug the machine and ensure that the product is off before maintenance.

Install according to the filter sticker (Air inlet direction) to avoid mistakes.

It is best to wear gloves when replacing the filter element, and put the old filter in a plastic bag and dispose of it according to the garbage classification to prevent secondary pollution of the environment.

The function and service life of the product will be affected if the filter is not inspected, cleaned and replaced regularly.

Daily cleaning

Please use a soft, dry cloth to clean the machine;

Use a soft, dry cloth to clean the dust from the air inlet and air outlet regularly to prevent dust accumulation.

Replace the filter

Maintenance of the EPA filter:

Do not wash the filter;

During use, do not use sharp objects to puncture the EPA filter. This will reduce or even damage the filtering capacity of the filter. When the replacement interface display, please confirm and replace the filter.

Special hints:

Do not install the used filter element in reverse, otherwise the dust adsorbed by the filter element may be sucked out by the wind and cause pollution.

Replace the UV lamp

Maintenance of the UV lamp tube:

Do not spill water into the socket of the UV lamp tube;

When using product, do not touch or knock the UV lamp with hard object. Otherwise the glass tube of the UV lamp will be damaged easily.

When replacing the UV lamp, make sure to pull the power plug off from the power outlet. Operations are forbidden when the power is on to prevent electric shock.

After replacing the UV lamp, do not forcibly power on or look at the UV lamp with your eyes if it is not covered with the filter in case that your eyes will be injured by UV light.

Used UV lamps should be put into the special recycling bins for lamp tubes to prevent the hydrargyrum from polluting environment.

Common problems

Common problem	Troubleshooting	Solution
The machine is not running	<ul style="list-style-type: none">● The power is not plugged in, or the socket is not in good contact.● The filter life has expired or the filter is too dirty.	<ul style="list-style-type: none">● Plug the power and ensure good contact.
Loud noise	<ul style="list-style-type: none">● Check to see whether the filter blocked	<ul style="list-style-type: none">● Replace with a new filter or unblock the filter.
Poor odor removal effects	<ul style="list-style-type: none">● Filter service life has expired.● The air inlet is blocked by foreign matter.● The use area exceeds the machine use area.	<ul style="list-style-type: none">● Please replace the filter element in time.● Please remove foreign matter from the air inlet.● Please use it within the appropriate area.
UV lamp tube does not function	<ul style="list-style-type: none">● Filter is not installed● The service life of the filter or the UV lamp tube ends● The terminals of the UV lamp tube are not inserted properly	<ul style="list-style-type: none">● Reinstall the filter properly● Replace the filter or the UV lamp● Reinstall the terminals of the UV lamp tube properly

- Methods to check whether the UV lamp tube functions normally:
Observe the inside wall (in a darker environment) of the machine through the air outlet. By turning on/off, the process in which the UV lamp inside the machine will turn from dim to bright can be observed, which indicates that the UV lamp functions normally.
- If you need services or wan to purchase filters and other supplies, please call our customer service line 4009-21-3058.

安全重要提示

- 使用前请详细阅读本操作说明指示,并妥善保管,以供日后参考。
- 本说明书适用于DAS180系列型号,请依所购买机型操作。
- 当我们在使用电器用品时,应具备最基本的安全常识,以避免火灾、触电以及其他伤害的发生。

因此,请遵守以下指示:



请将本产品放在距离阻挡物体相距至少10cm的地方。



产品表面请勿覆盖毛巾等物体,保持周围空气畅通。



使用电器用品应注意避免火灾、电击和伤害的危险。



请将本产品放在房间水平桌面和空气易循环的地方使用。



请勿将产品放置在易碰到窗帘的地方。



本空气消毒机必须直立使用。

安全重要提示



严禁用湿手进行操作, 禁止用液体直接清洗。



禁止进出口有异物。产品内部含有高速旋转的电机, 防止意外伤害或损坏产品。



禁止将空气净化器作为玩具给儿童玩耍。



如果电源软线损坏, 为了避免危险, 必须由制造商、其维修部或类似部门的专业人员更换。



禁止在浴室或有燃气的地方使用本机。



非专职人员或未授权修理人员, 不得自行修理或改造本机。

【使用前准备工作】

- 将本产品从包装盒中取出, 置于桌面或平坦地板上。机体离墙壁或其他家居至少60公分以上, 利于空气循环。
- 避免儿童或不了解本产品的人使用。
- 您可以开始使用空气消毒机, 畅享新鲜空气。

注意: 使用前请移开所有包装材料以免堵住进出风口。

部品名称

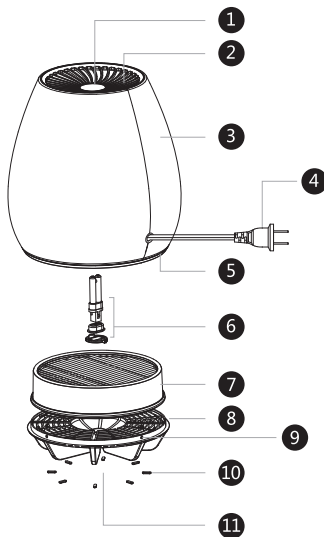

- | | | |
|--------|--------|---------|
| 1 控制面板 | 2 出风口 | 3 主机 |
| 4 电源线 | 5 氛围灯 | 6 UV灯组件 |
| 7 滤网 | 8 进风格栅 | 9 弹扣 |
| 10 脚垫 | 11 进风口 | |

部品规格

产品	Dustie 达氏 空气消毒机
型号	DAS180
额定电压	220V ~ /50Hz
输入功率	10.0 W
尺寸	240(宽)x281(高) mm
集尘模式	后向离心风道系统
风量	100m ³ /h
除菌率	>99% (*1)
氨气CADR	60m ³ /h (*2)
适用空间	30-45m ³
重量	2.16 kg

* 注1: 执行标准GB2155.3-2010 附录A

* 注2: 执行标准GB/T 18801-2015 附录C

* 注3: 执行标准4706.1-2005/4706.45-2008

操作指导与产品维护

一、产品操作

1. 将机器放在水平台面上，并确保遵守照第一页的注意事项后使用。

2. 插电源

请将机器电源线插头插入电压为220V，频率为50Hz的电源插座中，并保证接触良好。

注意：不要用湿手插拔插头，以免触电。移动机器时，要拔掉电源插头。

3. 开/关机

轻触电源键 ，显示屏界面亮起，产品开机；复按产品关机。

产品有开/关机和弦音、按键音，表示每次触摸动作有效。

4. 模式切换

开机后轻触模式键 ，实现模式切换，顺序如右图：



5. 风速

开机后风速键随模式自动切换最佳风速，顺序如右图：



6. 滤网/UV灯更换重置

滤网/UV灯使用到期后，产品会进入更换提醒模式，此时产品显示屏会出现警示页面，风机会停止工作，表示您需要更换滤网或UV灯，以防止用过旧的滤网或UV灯影响到您的使用。

(重置办法：按住电源键  + 模式键  超过3秒，即可解除警示模式，之后重新开机产品恢复运行)



注：如果滤网未安装或安装不正确，显示屏会出现警示提醒，此时请按说明书正确安装好滤网，产品会自动恢复工作。



操作指导与产品维护

7. 工厂重置

滤网/UV灯未到期发生更换,需要作业员手动进入工厂模式重置!
否则产品会出现新更换的滤网/UV灯提前出现“使用到期提醒”的情况。

重置办法:在待机状态下,按住电源键⏻+模式键⏮超过3秒,进入图(1)工厂重置界面,再依图(2)作相应的重置:按模式键⏮表示重置滤网,按电源键⏻表示重置UV灯。重置完成后,3秒钟后产品会自动进入待机状态,重新按电源键开机即可正常使用了。

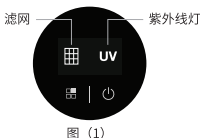

8. 氛围灯开/关

连续轻触电源键两下,可切换氛围灯的亮与关。每次开机默认为开启。

友情提示:

依照使用环境不同,滤网使用约3-6个月左右更换一次;

UV灯管使用约1~2年左右更换一次。

操作指导

二、滤网更换

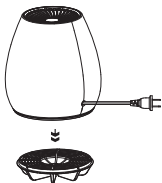

1. 关机，拔下电源，取进风格栅

- A. 轻触产品电源键关机；
- B. 拔下产品电源插头；
- C. 将产品倒置后，轻轻用力将进风格栅沿箭头方向拔出。

2. 取出旧滤网

握住滤网提手，将旧滤网沿箭头方向取出。

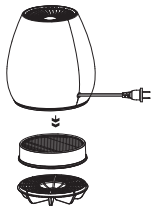

3. 取出新滤网

用剪刀打开新滤网的密封袋，取出新滤网。

产品维护

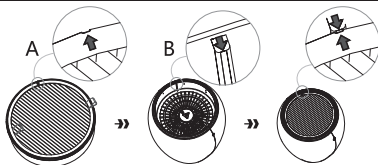

4. 装入新滤网

双手握住新滤网的提手，垂直放入主机的滤网槽内。

注意：要将滤网的箭头A对准滤网槽B位置垂直放入。

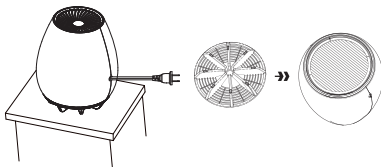

5. 装回进风格栅

将进风格栅沿箭头方向垂直装入主机。

然后将产品正放于水平桌面上，重新插电使用。

提示：

1. 每次更换完新的滤网后，需要您依显示屏提示说明，手动重置后才可使用！

重置办法：按住电源键  + 模式键  超过3秒，即可解除警示模式，之后可放心继续使用。

2. 滤网未到期发生更换，需要作业员手动进入工厂模式重置(详见“工厂重置”叙述说明)！

三、UV灯更换

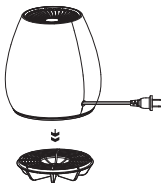

1. 关机，拔下电源，取进风格栅

- A. 按住产品电源键大于3秒钟，关机；
- B. 拔下产品电源线插头；
- C. 将产品倒置后，轻轻用力将进风格栅沿箭头方向拔出。

2. 取出滤网

握住滤网提手，将旧滤网沿箭头方向取出。

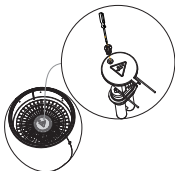
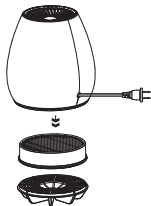

3. 取出旧UV灯管

用专业螺丝刀将一颗固定螺丝扭出，取出UV灯的安全压盖，解开L/N电极两只端子，将UV灯沿轴向抽出。

*注意：取UV灯管时，一定要断电操作，防止触电。

产品维护

4. 装入新的UV灯管

- A. 小心取一只新UV灯管，套上UV灯护套
- B. 将UV灯插入产品的基座内
- C. 插回L/N电极端子
- D. 盖上UV灯盖
- E. 重新用自攻螺丝固定牢固

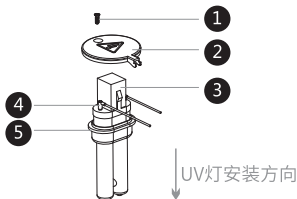

- | | | |
|---------|---------|-------|
| 1 自攻螺丝 | 2 UV灯盖 | 3 UV灯 |
| 4 L/N端子 | 5 UV灯护套 | |

5. 装回滤网,盖好进风栅格

重新装回滤网(注意对位),盖好进风栅格,依屏幕提示重新开机即可。

提示:

1. 每次更换完新的UV灯管后,需要您依显示屏提示说明,手动重置后才可使用!

重置办法: 按住电源键  + 模式键  超过3秒, 即可解除警示模式, 之后可放心继续使用。

2. UV灯管未到期发生更换, 需要作业员手动进入工厂模式重置(详见“工厂重置”叙述说明)!

四、清洁与保养

滤网维护前请确认产品是关机状态，并拔电。

依滤网贴纸提示要求安装（进风方向），避免装错。

更换滤网组件时最好佩戴手套，并将旧滤网用塑胶袋装好后按垃圾分类废弃处理，以防旧滤网内的污染物对环境造成二次污染。

不定期检查清洁更换滤网，会影响产品使用及寿命。

日常清洁

请使用柔软的干布清洁；

请定期使用柔软干布清洁机身及进风口/出风口的灰尘，防止灰尘积聚。

更换滤网

EPA网的维护：

请勿水洗滤网；

使用过程中，请勿用尖物对EPA滤网进行刺扎，这样会降低甚至破坏滤网过滤能力；

当更换提示界面出现时，请及时确定并更换。

特别提醒：

请勿将已使用过的滤网组件反向安装使用，否则滤网组件所吸附的灰尘可能会因风力逃逸吸出，造成污染。

更换UV灯

UV灯管的维护：

请勿将水洒入UV灯管的插座内；

使用过程中，请勿用硬的物体碰触、敲打UV灯，这样易损坏UV灯的玻璃管。

更换UV灯时，一定要将电源插头从电源插座中拔下，禁止带电作业，防止触电。

更换UV灯后，未盖回滤网禁止强行开机和用眼睛直视UV灯管，防止紫外光误伤人眼。

废旧的UV灯，需要放入灯管专用回收桶内，防止水银破坏环境。

常见问题

常见故障	常见原因	解决方法
机器不运行	<ul style="list-style-type: none">● 电源未插, 或插座接触不良。● 滤网寿命过期或滤网太脏污。	<ul style="list-style-type: none">● 请插好电源插头, 并确保接触良好
噪音大	<ul style="list-style-type: none">● 滤网是否堵塞。	<ul style="list-style-type: none">● 更换新滤网或排出堵塞物。
除臭效果差	<ul style="list-style-type: none">● 滤网使用寿命已到。● 进风口被异物堵塞。● 使用面积超过机器使用面积。	<ul style="list-style-type: none">● 请及时更换滤网组件。● 请移除进风口异物。● 请在适合面积内使用。
UV灯管不工作	<ul style="list-style-type: none">● 未放滤网● 滤网到期或UV灯管到期● UV灯管端子未插好	<ul style="list-style-type: none">● 重新正确放入滤网● 更换滤网或UV灯管● 拔电后重新插好UV 灯管端子

- 如果想查看UV灯管是否正常工作,方法是:
可以从出风口观察机器内侧壁(在较暗的环境下),通过开/关机,可以观察到机器内UV灯启动变亮的切换过程,以判定UV灯是否在正常工作。
- 如需要服务或购买过滤器灯耗材, 请联络顾客服务专线4009-21-3058。

Consumer Warranty Card

消费者保修卡

Name 姓名			
Gender 性别	<input type="checkbox"/> Male 男士	<input type="checkbox"/> Female 女士	Mobile 行动电话
Address 住址			
E-mail 电子邮箱			
Product Name 产品名称		Model NO. 产品型号	
空气消毒机		DAS180	
Serial Number 产品序列号			
Date of Purchase 购买日期		Y 年	M 月
			D 日
Notes 备注			

保修说明：

在正确使用方式下，自购买日期起12个月内，如因制造商的瑕疵而发生故障则免费维修（不包含过滤器）。

*一切人为损坏、天灾、地震、不在保证范围内。

*产品保修期内，若需要维修，请拨打客户：4009-21-3058

*若超过保修期限，则需酌收维修棚费用。

*请妥善保存购机凭证，例如订单单、送货单等。

以下情况恕不保修：

*无保修卡及有效凭证。

*非本公司指定维修部维修而自行拆装修理引起的损坏。

*跌落或使用不当造成损坏。

*耗材类不在保修范围内。例如：过滤器、灯管和电池等。

在实施本公司保修标准过程中，我司保留以上条款的解释权。当您在接受或需要服务时有不明之处，请咨询我司客户服务热线。

*保修服务区域仅限中国国内（不包含港、澳、台地区）。

QRcode
Here